

CONSTRUCTION OF 2 BLOCKS OF 4-STANCE BATHING SHELTERS IN GOROM REFUGEE SETTLEMENT

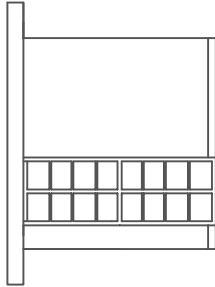

SIDE VIEW

PLAN

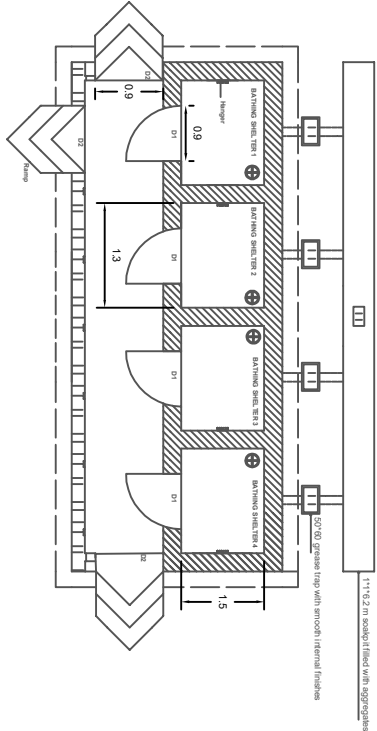
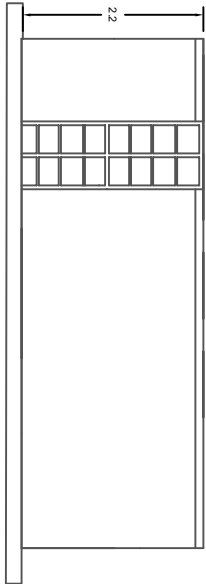

FRONT VIEW

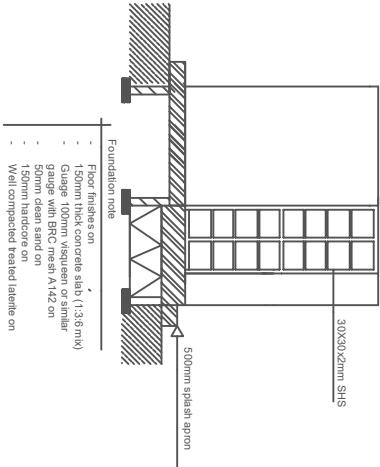

NOTE

1. All dimensions are in meters unless stated
2. All doors 900mm wide.
3. All walls are 200mm thick
4. Metal boxes are 20x15cm

DRAWING SCALE
1:100