

**ROOF NOTE**

28 pitch roof on:-  
28 gauge prepainted G.I sheet on  
75x50 s/w purline on  
100x50 s/w common rafters on  
150x50 s/w tie beam on  
100x75 s/w wall plate

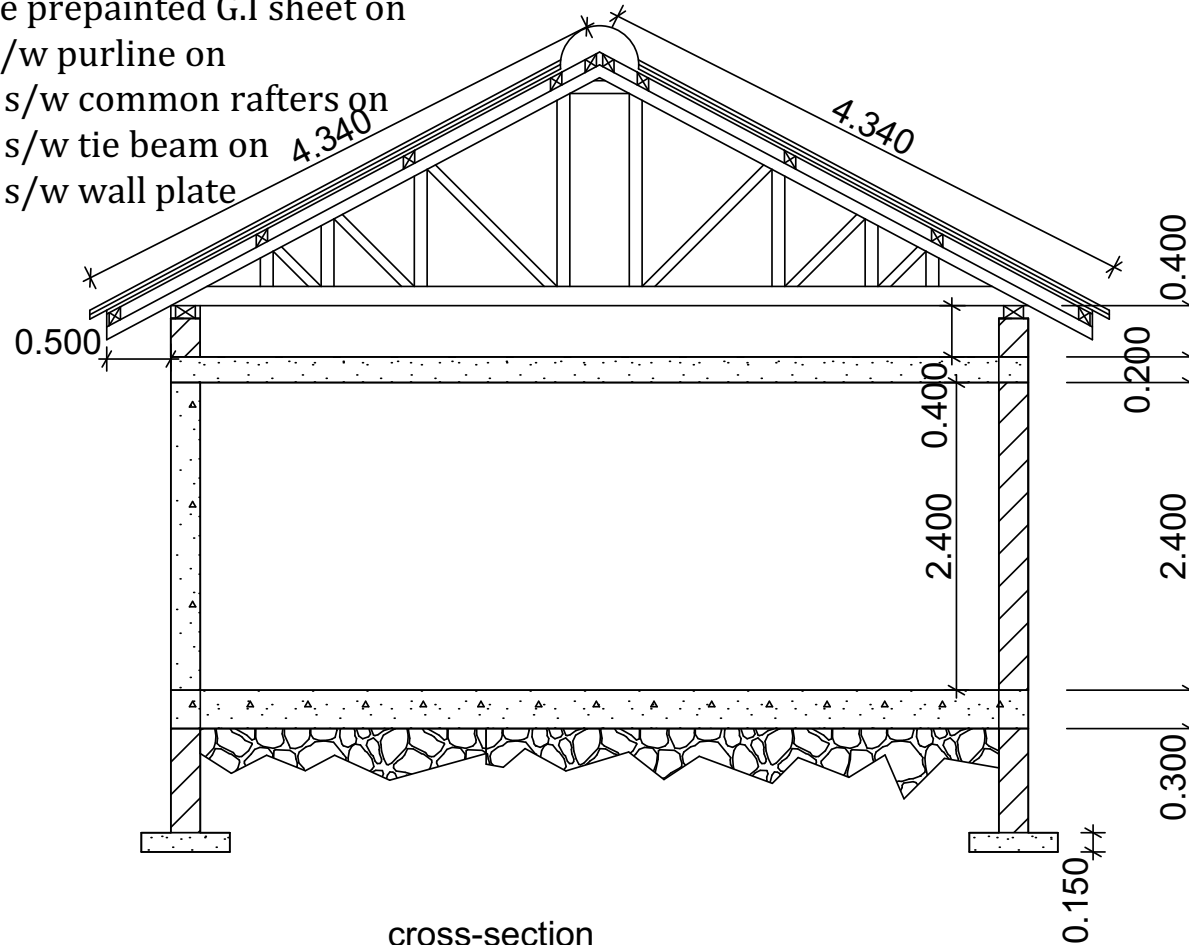

**FOUNDATION NOTE**

25 mm cement screed mix 1:3  
100mm oversite concrete mix 1:3:6  
300mm hardcore filling on well  
compacted ground.  
230mm wall thickness to be built  
in mix 1:4

**CROSS-SECTION FOR NUTRITION SITE IN KAPOETA MISSION HOSPITAL**