

BILLS OF QUANTITIES					
FOR THE PROPOSED STANDARD MODULE (2) LATRINE IN GOLLO & OTTEGO PHCC					
#	DESCRIPTION OF ITEMS	Unit	Qty	Cost, USD	
				Unit price	Total price
<b>1</b>	<b>EARTH WORK</b>				
1.1	Excavation and backfill for the pit of all kind of sub surface materials and complete in all respect as shown on drawing and specification and or as directed by the engineer. surplus materials should be removed from the site or used in the land scaping or as directed by the engineer	m <sup>3</sup>	17.34		
	<b>Sub total for earthwork</b>				
<b>2</b>	<b>GROUND REINFORCED CONCRETE SLAB AND BEAM</b>				
2.1	Providing and laying of 0.05m thick plain concrete blinding slab of mix cement, sand, aggregates (1:3:6 ) using coarse sand and aggregate.	m <sup>3</sup>	0.45		
2.2	Provide and cast 0.20mx0.20m reinforced concrete intermediate beam of mix 1:2:4 on as shown on the drawing to support the super structural weight and transmit to the natural foundation/earth	m <sup>3</sup>	0.48		
2.3	Providing and laying of 0.15m thick reinforced concrete floor slab monolithically with grade beam 0.20mx0.20m of mix cement, sand, aggregates. (1:2:4) using coarse sand and aggregates in required shape and design including cost of Y12 reinforcement bars, binding wire, vibrating and curing,	m <sup>3</sup>	0.47		
2.4	Provide and cast 0.20mx0.20m reinforced concrete for support columns of mix 1:2:4 including reinforced steel bar	m <sup>3</sup>	1.08		
2.5	Provide and fixing reinforced steel bar y12	N0	26.00		
2.6	Provide and fixing reinforced steel bar R8	N0	18.00		
2.7	provide Binding wire for fixture of steel	Roll	4.00		
2.8	Provide and cast 0.20mx0.20m reinforced concrete Grade beam of mix 1:2:4 on or to support the super structural weight and transmit to the natural foundation/earth	m <sup>3</sup>	0.32		
2.9	Supply and construct pit latrine wall lining with well burnt clay bricks of dimension 0.2mx0.1m x0.1m and lay in an header bond in 0.01m thick cement sand mortar of mix ratio 1: 4 as per the drawing or as directed by the engineer	m <sup>2</sup>	31.07		
	<b>Subtotal for reinforced slab and beams</b>				
<b>4</b>	<b>BRICK WORK ABOVE THE SLAB LEVEL</b>				
4.1	Supply well burnt clay bricks of dimension 0.22mX0.1m X0.01m and lay in an English bond in 0.01m thick cement sand mortar of mix ratio 1: 4 as per the drawing or as directed by the engineer	m <sup>2</sup>	16.92		
	<b>Sub total for brick work</b>				
<b>5</b>	<b>ROOFING</b>				
5.1	Providing and construct flat timber roof structure as shown on the drawing, including laying of 28G colored iron sheet, fascia board and all timber members should be treated with approved wood preservative. Note: this price include 150mm dia. PVC pipe installation	m <sup>2</sup>	7.65		
	<b>Sub total for roofing</b>				
<b>6</b>	<b>DOORS AND WINDOWS</b>				
6.1	Supply and install well fabricated and approved casement doors of dimensions 2.4mX0.9m as shown on the drawings	No.	2.00		
6.2	Supply and install well fabricated and approved 0.8mX0.3m casement window in the toilet rooms as shown on the drawing	m <sup>3</sup>	2.00		

6.3	supply and fix of Inspection Hatch top made of mettalic frame	N0	4.00		
<b>Sub total for the doors and windows</b>					
<b>8</b>	<b>PLASTERING</b>				
8.1	Apply 0.012m thick cement sand plastering mortar of mix ratio (1:4) on both interior and exterior wall surfaces, and interior face should be smooth finishing using steel float and light broom finishing on exterior face. Note: these costs include floor screed of 0.025m thickness with steel float smooth finishing and no dry cement powder shall be used in any finishing work	M2	39.72		
<b>Sub total for plastering</b>					
<b>9</b>	<b>PAINTING</b>				
9.1	Prepare wall surface and apply filler, undercoat and two coats of weather resistant paint on interior and exterior wall faces. The paint color will be approved by the client	m <sup>2</sup>	39.72		
<b>Sub total for painting</b>					
<b>Sub Total</b>					
<b>Add 5% Contingency</b>					
<b>GRAND TOTAL COST FOR WAU HOSPITAL FOUR STAND PIT LATRINE</b>					

Company Name:

Signature

Company Stamp

SHEET LIST	
SHEET#	SHEET NAME
G100	COVER
A110	PLAN OFF PIT
A120	FLOOR PLAN
A130	ELEVATION VIEWS
A140	CROSS SECTION

DRAWINGS AND SPECIFICATION

Construction of standard module 2 Latrine at Gollo& Olego

NOTES	DESIGN BY	PROJECT NAME	DRAWING:		SCALE	SHEET NUMBER
	CORDAID	CONSTRUCTION OF LATRINE	SHEET NAME	COVER	1:100	G100
	SOUTH-SUDAN				Plot Number	
					APRIL, 2022	

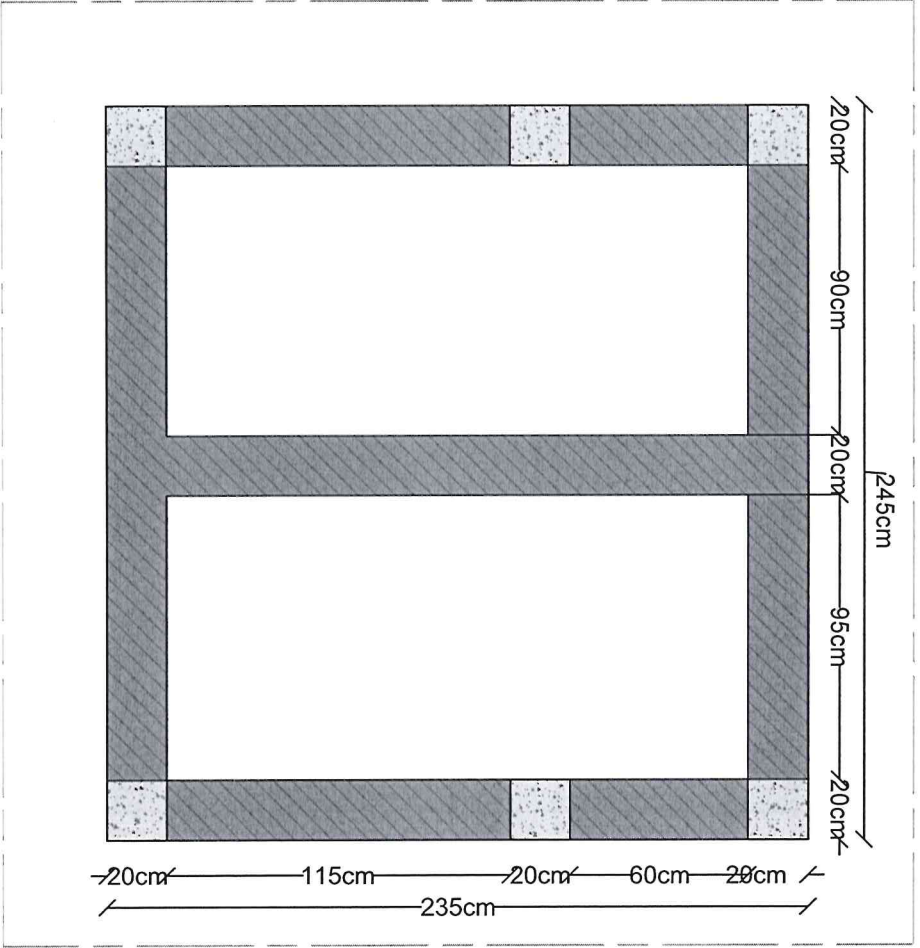

# PLAN OFF PIT

NOTES		DESIGN BY		PROJECT NAME		DRAWING:	
		CORDAID		CONSTRUCTION OF LATRINE		SHEET NAME	
		SOUTH-SUDAN				PLAN OFF PIT	
						SCALE	SHEET NUMBER
						1:100	A110
						PLOT DATE	
						MAY 2022	



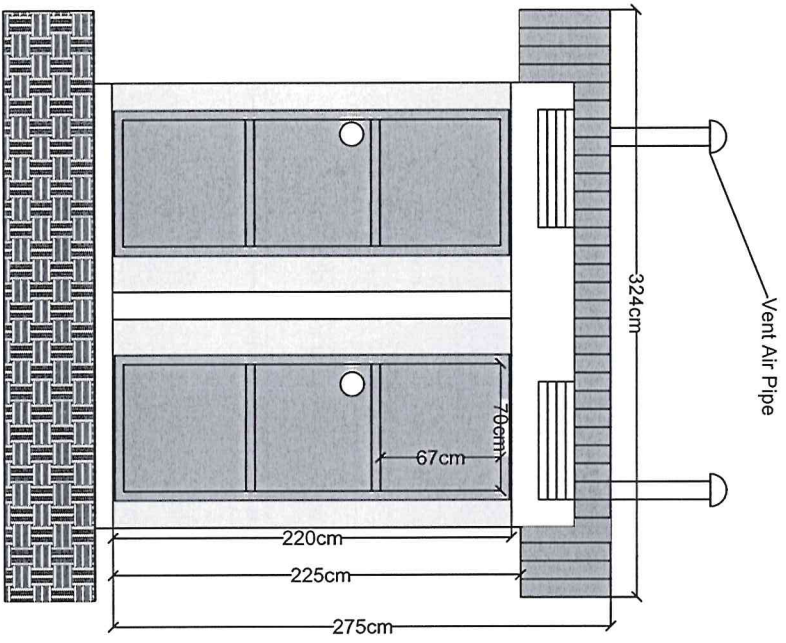

FRONT ELEVATION

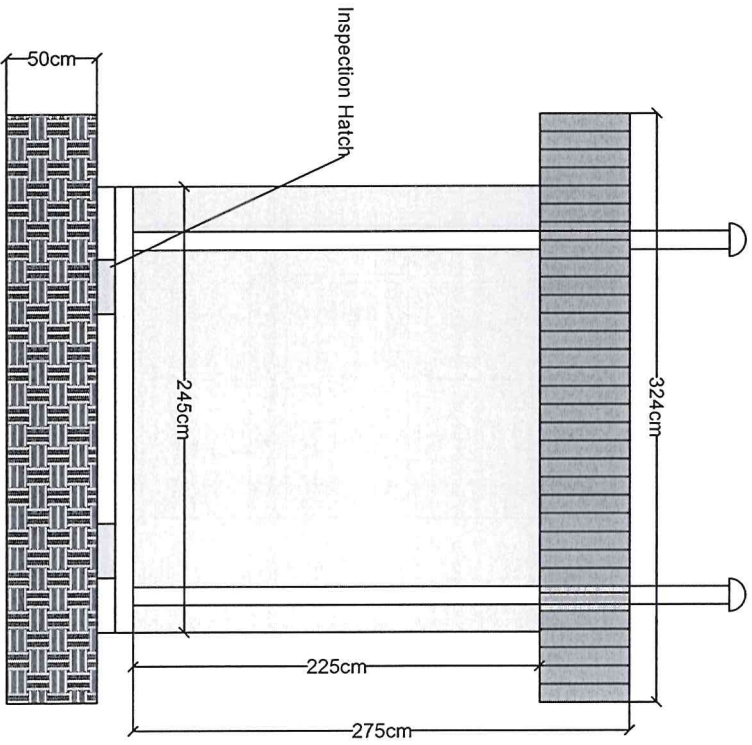

REAR ELEVATION

NOTES	DESIGN BY	PROJECT NAME	DRAWING:		SCALE	SHEET NUMBER
	<b>CORDAID</b>	CONSTRUCTION OF LATRINE	SHEET NAME	ELEVATION	1:100	A130
	SOUTH -SUDAN				PLOT DATE	
					MAY, 2022	

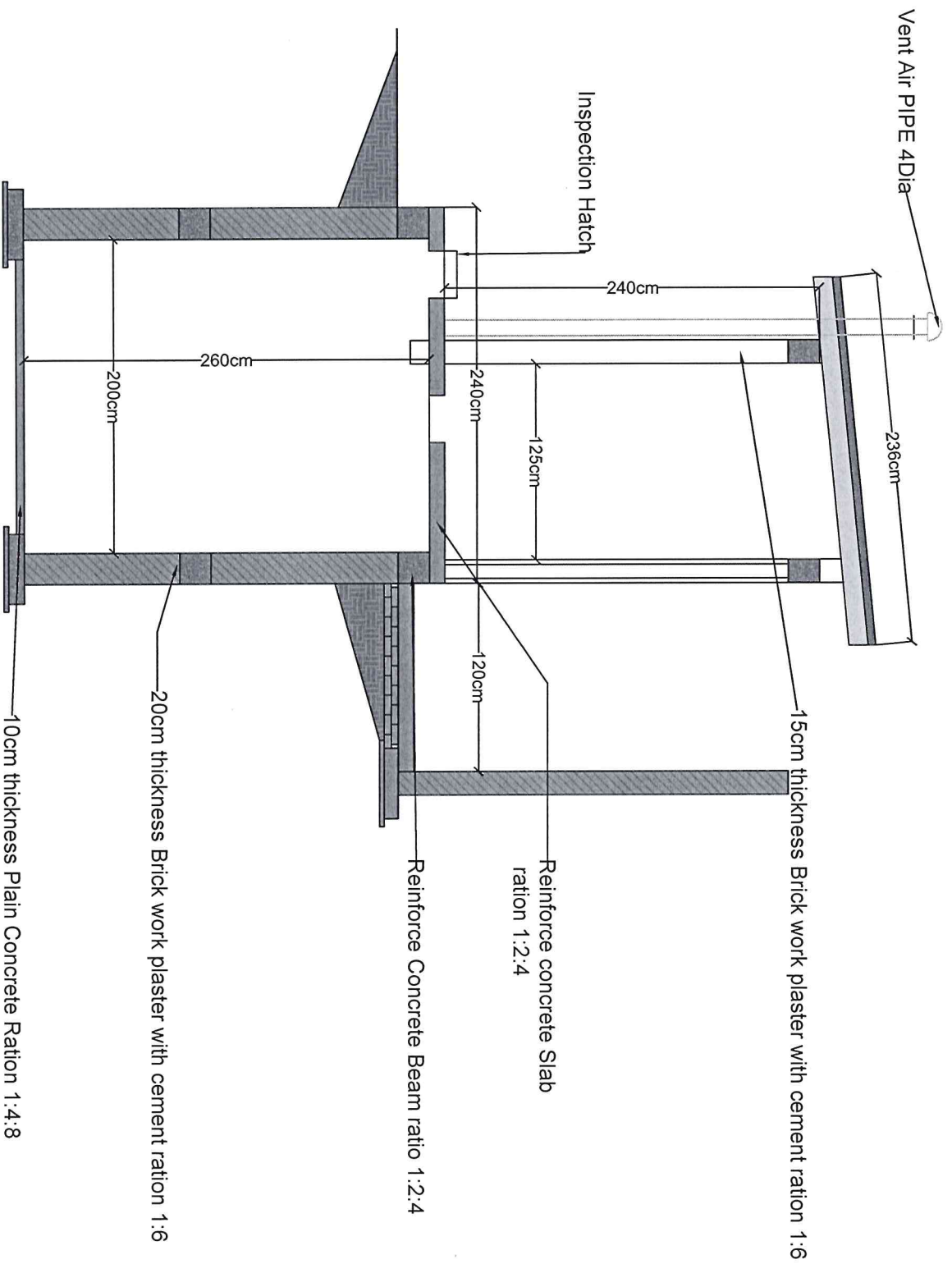

NOTES	DESIGN BY	PROJECT NAME	DRAWING:	
	<b>CORDAID</b>	CONSTRUCTION OF LATRINE	SHEET NAME	SHEET NUMBER
			X-CROSS SECTION	A140
			SCALE	
			1:100	
			PLOT DATE	
			MAY, 2022	